

DIP MOLDED VINYL PRODUCTS

CAPS

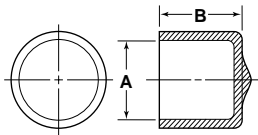

A=TO FIT	LENGTH B=1/2"	LENGTH B=3/4"	LENGTH B=1"	LENGTH B=1-1/4"	LENGTH B=1-1/2"
1/16"	DM-0062-1/2	DM-0062-3/4	DM-0062-1	DM-0062-1-1/4	DM-0062-1-1/2
5/64"	DM-0080-1/2	DM-0080-3/4	DM-0080-1	DM-0080-1-1/4	DM-0080-1-1/2
3/32"	DM-0093-1/2	DM-0093-3/4	DM-0093-1	DM-0093-1-1/4	DM-0093-1-1/2
7/64"	DM-0110-1/2	DM-0110-3/4	DM-0110-1	DM-0110-1-1/4	DM-0110-1-1/2
1/8"	DM-0125-1/2	DM-0125-3/4	DM-0125-1	DM-0125-1-1/4	DM-0125-1-1/2
9/64"	DM-0140-1/2	DM-0140-3/4	DM-0140-1	DM-0140-1-1/4	DM-0140-1-1/2
5/32"	DM-0156-1/2	DM-0156-3/4	DM-0156-1	DM-0156-1-1/4	DM-0156-1-1/2
11/64"	DM-0172-1/2	DM-0172-3/4	DM-0172-1	DM-0172-1-1/4	DM-0172-1-1/2
3/16"	DM-0187-1/2	DM-0187-3/4	DM-0187-1	DM-0187-1-1/4	DM-0187-1-1/2
13/64"	DM-0207-1/2	DM-0207-3/4	DM-0207-1	DM-0207-1-1/4	DM-0207-1-1/2
15/64"	DM-0234-1/2	DM-0234-3/4	DM-0234-1	DM-0234-1-1/4	DM-0234-1-1/2
1/4"	DM-0240-1/2	DM-0240-3/4	DM-0240-1	DM-0240-1-1/4	DM-0240-1-1/2
1/4"	DM-0250-1/2	DM-0250-3/4	DM-0250-1	DM-0250-1-1/4	DM-0250-1-1/2
9/32"	DM-0281-1/2	DM-0281-3/4	DM-0281-1	DM-0281-1-1/4	DM-0281-1-1/2
5/16"	DM-0313-1/2	DM-0313-3/4	DM-0313-1	DM-0313-1-1/4	DM-0313-1-1/2
11/32"	DM-0343-1/2	DM-0343-3/4	DM-0343-1	DM-0343-1-1/4	DM-0343-1-1/2
23/64"	DM-0360-1/2	DM-0360-3/4	DM-0360-1	DM-0360-1-1/4	DM-0360-1-1/2
3/8"	DM-0375-1/2	DM-0375-3/4	DM-0375-1	DM-0375-1-1/4	DM-0375-1-1/2
13/32"	DM-0406-1/2	DM-0406-3/4	DM-0406-1	DM-0406-1-1/4	DM-0406-1-1/2
7/16"	DM-0437-1/2	DM-0437-3/4	DM-0437-1	DM-0437-1-1/4	DM-0437-1-1/2
12MM	DM-0470-1/2	DM-0470-3/4	DM-0470-1	DM-0470-1-1/4	DM-0470-1-1/2
1/2"	DM-0500-1/2	DM-0500-3/4	DM-0500-1	DM-0500-1-1/4	DM-0500-1-1/2
17/32"	DM-0523-1/2	DM-0523-3/4	DM-0523-1	DM-0523-1-1/4	DM-0523-1-1/2
17/32"	DM-0531-1/2	DM-0531-3/4	DM-0531-1	DM-0531-1-1/4	DM-0531-1-1/2
35/64"	DM-0544-1/2	DM-0544-3/4	DM-0544-1	DM-0544-1-1/4	DM-0544-1-1/2
9/16"	DM-0562-1/2	DM-0562-3/4	DM-0562-1	DM-0562-1-1/4	DM-0562-1-1/2
5/8"	DM-0625-1/2	DM-0625-3/4	DM-0625-1	DM-0625-1-1/4	DM-0625-1-1/2
11/16"	DM-0677-1/2	DM-0677-3/4	DM-0677-1	DM-0677-1-1/4	DM-0677-1-1/2
11/16"	DM-0687-1/2	DM-0687-3/4	DM-0687-1	DM-0687-1-1/4	DM-0687-1-1/2
3/4"	DM-0750-1/2	DM-0750-3/4	DM-0750-1	DM-0750-1-1/4	DM-0750-1-1/2
13/16"	DM-0812-1/2	DM-0812-3/4	DM-0812-1	DM-0812-1-1/4	DM-0812-1-1/2
27/32"	DM-0843-1/2	DM-0843-3/4	DM-0843-1	DM-0843-1-1/4	DM-0843-1-1/2
7/8"	DM-0875-1/2	DM-0875-3/4	DM-0875-1	DM-0875-1-1/4	DM-0875-1-1/2
15/16"	DM-0937-1/2	DM-0937-3/4	DM-0937-1	DM-0937-1-1/4	DM-0937-1-1/2
1"	DM-1000-1/2	DM-1000-3/4	DM-1000-1	DM-1000-1-1/4	DM-1000-1-1/2
1-1/16"	DM-1062-1/2	DM-1062-3/4	DM-1062-1	DM-1062-1-1/4	DM-1062-1-1/2
1-1/8"	DM-1125-1/2	DM-1125-3/4	DM-1125-1	DM-1125-1-1/4	DM-1125-1-1/2
1-3/16"	DM-1187-1/2	DM-1187-3/4	DM-1187-1	DM-1187-1-1/4	DM-1187-1-1/2
1-1/4"	DM-1250-1/2	DM-1250-3/4	DM-1250-1	DM-1250-1-1/4	DM-1250-1-1/2
1-3/8"	DM-1375-1/2	DM-1375-3/4	DM-1375-1	DM-1375-1-1/4	DM-1375-1-1/2
1-1/2"	DM-1500-1/2	DM-1500-3/4	DM-1500-1	DM-1500-1-1/4	DM-1500-1-1/2
1-5/8"	DM-1625-1/2	DM-1625-3/4	DM-1625-1	DM-1625-1-1/4	DM-1625-1-1/2
1-3/4"	DM-1750-1/2	DM-1750-3/4	DM-1750-1	DM-1750-1-1/4	DM-1750-1-1/2
1-7/8"	DM-1875-1/2	DM-1875-3/4	DM-1875-1	DM-1875-1-1/4	DM-1875-1-1/2
2"	DM-2000-1/2	DM-2000-3/4	DM-2000-1	DM-2000-1-1/4	DM-2000-1-1/2
2-1/8"	DM-2125-1/2	DM-2125-3/4	DM-2125-1	DM-2125-1-1/4	DM-2125-1-1/2
2-1/4"	DM-2250-1/2	DM-2250-3/4	DM-2250-1	DM-2250-1-1/4	DM-2250-1-1/2
2-1/2"	DM-2500-1/2	DM-2500-3/4	DM-2500-1	DM-2500-1-1/4	DM-2500-1-1/2
3"	DM-3000-1/2	DM-3000-3/4	DM-3000-1	DM-3000-1-1/4	DM-3000-1-1/2

Max length: Dip lengths are available up to 12"; certain tools however may be limited to length.

SPECIFICATIONS - STANDARD CAPS

- Standard Color: Black
- Standard Material: Vinyl I (PVC)
- Temperature Range: Up to 350 °F

SPECIFICATIONS - HIGH-TEMP. CAPS

- Standard Color: Yellow
- Standard Material: High Temperature Vinyl (PVC)
- Temperature Range: Up to 450 °F
- To order High Temperature items, add "H" suffix to the Part Number
(Example: DM-0187-1/2H)

DM Series

Provides a low-cost solution for a variety of user applications as protectors for tubing, threaded parts, and as covers for bolts and screws. Widely used as masks for painting, plating, shot blasting and powder coating processes. Available in standard or high-temperature material. Flexible design can stretch onto slightly larger dimensions for a snug fit without tearing, splitting or shredding. Available in custom sizes, alternate colors, and optional lengths if sizes shown are not applicable.

DIP MOLDED VINYL PRODUCTS



A=TO FIT	LENGTH B=1/2"	LENGTH B=1"	MAX LENGTH
1/2"	DMSQ-0500-1/2	DMSQ-0500-1	AVAILABLE IN CUSTOM LENGTHS UP TO 5-3/4"
3/4"	DMSQ-0750-1/2	DMSQ-0750-1	
1"	DMSQ-1000-1/2	DMSQ-1000-1	
1-1/4"	DMSQ-1250-1/2	DMSQ-1250-1	
1-1/2"	DMSQ-1500-1/2	DMSQ-1500-1	
2"	DMSQ-2000-1/2	DMSQ-2000-1	

SPECIFICATIONS - STANDARD CAPS

- Standard Color: Black
- Standard Material: Vinyl (PVC)
- Temperature Range: Up to 350 °F

SPECIFICATIONS - HIGH-TEMPERATURE CAPS

- Standard Color: Yellow
- Standard Material: High-Temperature Vinyl (PVC)
- Temperature Range: Up to 450 °F
- To order High Temperature items, add "H" suffix to the Part Number
(Example: DMSQ-0500-1/2H)

DMSQ Series

Designed to fit most popular sizes of square tubular steel. Material flexibility allows stretching to fit normal tube diameter variations. A durable, glossy finish makes this part ideal for use as decorative end cap. Available in custom sizes, alternate colors and optional lengths if sizes shown are not applicable.

SQUARE CAPS

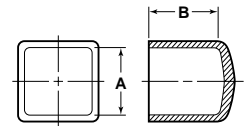
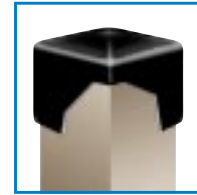

VGRD Series (ROUND)

PART NUMBER	"A" INSIDE DIAMETER		"B" INSIDE LENGTH	WALL THICKNESS STANDARD		WALL THICKNESS TEXTURED							
	IN.	MM		IN.	MM	IN.	MM						
VGRD-0687-	0.687	17.45	AVAILABLE IN CUSTOM LENGTHS UP TO 12".	0.085	2.16	0.11	2.79						
VGRD-0750-	0.750	19.05		0.085	2.16	0.11	2.79						
VGRD-0812-	0.812	20.62		0.085	2.16	0.11	2.79						
VGRD-0843-	0.843	21.41		0.085	2.16	0.11	2.79						
VGRD-0875-	0.875	22.23		0.085	2.16	0.11	2.79						
VGRD-0937-	0.937	23.80		0.085	2.16	0.11	2.79						
VGRD-1000-	1.000	25.40		0.085	2.16	0.11	2.79						
VGRD-1062-	1.062	26.97		0.085	2.16	0.11	2.79						
VGRD-1125-	1.125	28.58		0.085	2.16	0.11	2.79						
VGRD-1187-	1.187	30.15		0.085	2.16	0.11	2.79						
VGRD-1250-	1.250	31.75		0.085	2.16	0.11	2.79						
VGRD-1375-	1.375	34.93		0.085	2.16	0.11	2.79						
VGRD-1500-	1.500	38.10		0.085	2.16	0.11	2.79						
VGRD-1625-	1.625	41.28		0.085	2.16	0.11	2.79						
VGRD-1750-	1.750	44.45		0.085	2.16	0.11	2.79						
VGRD-1875-	1.875	47.63		0.085	2.16	0.11 </tr <tr> <td>VGRD-2000-</td> <td>2.000</td> <td>50.80</td> <td>0.085</td> <td>2.16</td> <td>0.11</td> <td>2.79</td> </tr>	VGRD-2000-	2.000	50.80	0.085	2.16	0.11	2.79
VGRD-2000-	2.000	50.80		0.085	2.16	0.11	2.79						

When ordering STANDARD Material, add the "S" suffix after specifying desired length (Example: VGRD-0687-xxx-S).

When ordering TEXTURED Material, add the "T" suffix after specifying desired length (Example: VGRD-0687-xxx-T).

All grips are available in Standard or Textured Vinyl.

SPECIFICATIONS – STANDARD GRIPS

- Standard Color: Black
- Standard Material: Vinyl (PVC)
- Optional colors are available: consult factory

SPECIFICATIONS – TEXTURED GRIPS

- Standard Color: Black
- Standard Material: Textured PVC
- Optional colors are available: consult factory

VG, VGN, VGRD Series

Alliance Plastics offers an ample variety of the most commonly used grip styles: The VG Series Rectangular Grips and the VGRD Series Round Grips are used for numerous applications throughout many industries as ball valve handle covers, insulators, tubing end protectors and grips for tools, to name a few. The VGN Series Nubbed grips are ideal for applications requiring a uniform finger grasp. The lengths of all our Grips are customized to your specific requirements.

GRIPS

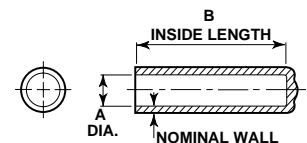

DIP MOLDED VINYL PRODUCTS

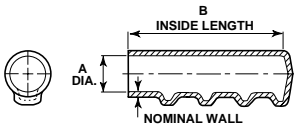

VGN Series (NUBBED)

PART NUMBER	"A" INSIDE DIAMETER		"B" INSIDE LENGTH	WALL THICKNESS STANDARD		WALL THICKNESS TEXTURED	
	IN.	MM		IN.	MM	IN.	MM
VGN-0750-	0.723	18.36	AVAILABLE IN CUSTOM LENGTHS UP TO 6"	0.085	2.16	0.11	2.79
VGN-0875-	0.844	21.44		0.085	2.16	0.11	2.79
VGN-1000-	0.965	24.51		0.085	2.16	0.11	2.79

When ordering STANDARD Material, add the "S" suffix after specifying desired length (Example: VGN-0750-xxx-S).
 When ordering TEXTURED Material, add the "T" suffix after specifying desired length (Example: VGN-0750-xxx-T).

SPECIFICATIONS – STANDARD GRIPS

- Standard Color: Black
- Standard Material: Vinyl (PVC)
- Optional colors are available; consult factory

SPECIFICATIONS – TEXTURED GRIPS

- Standard Color: Black
- Standard Material: Textured PVC
- Optional colors are available; consult factory

VGN Series (NUBBED)

The VGN Series Nubbled Grips are ideal for applications requiring a uniform finger grasp. The lengths of all our Grips are customized to your specific requirements.



VG Series (RECTANGULAR)

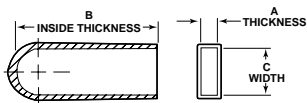

PART NUMBER	"A" INSIDE DIAMETER		"C" INSIDE WIDTH		"B" STANDARD INSIDE LENGTH	STANDARD WALL THICKNESS	
	IN.	MM	IN.	MM		IN.	MM
VG-1250500-	0.125	3.18	0.500	12.70	4.375*	0.07	1.780
VG-1250750-	0.125	3.18	0.750	19.05	4.375*	0.07	1.780
VG-1251000-	0.125	3.18	0.100	25.40	4.375*	0.07	1.780
VG-1870500-	0.187	4.76	0.500	12.70	4.375*	0.07	1.780
VG-2500750-	0.250	6.35	0.750	19.05	3.375*	0.07	1.780
VG-2501000-	0.250	6.35	1.000	24.40	4.375*	0.07	1.780
VG-2501250-	0.250	6.35	1.250	31.75	4.375*	0.07	1.780

*Dip lengths are available up to 8"; certain tools, however, may be limited to length.
 When ordering ROUND END, add the "R" suffix after specifying desired length (Example: VG-1250500-xxx-R).
 When ordering FLAT END, add the "F" suffix after specifying desired length (Example: VG-1250500-xxx-F).

SPECIFICATIONS – STANDARD GRIPS

- Standard Color: Black
- Standard Material: Vinyl (PVC)
- Optional colors are available; consult factory

SPECIFICATIONS – TEXTURED GRIPS

- Standard Color: Black
- Standard Material: Textured PVC
- Optional colors are available; consult factory

VG Series (RECTANGULAR)

The VG Series Rectangular Grips are used for numerous applications throughout many industries as ball valve handle covers, insulators, tubing end protectors and grips for tools, to name a few. The lengths of all our Grips are customized to your specific requirements.